

New Brighton Stockyard Days Parade - Float Info

Units 1-23 - 8th St NW- **south (right) side**
 Units 24-31 - 3rd Ave NW
 Units 36-49 - 8th St NW- **south (right) side**
 Units 50-74 - 8th St NW - **north (left) side**

Unit 3 - Fire Department
 Unit 15 - City Hall
 Units 33, 37-38 - St John's

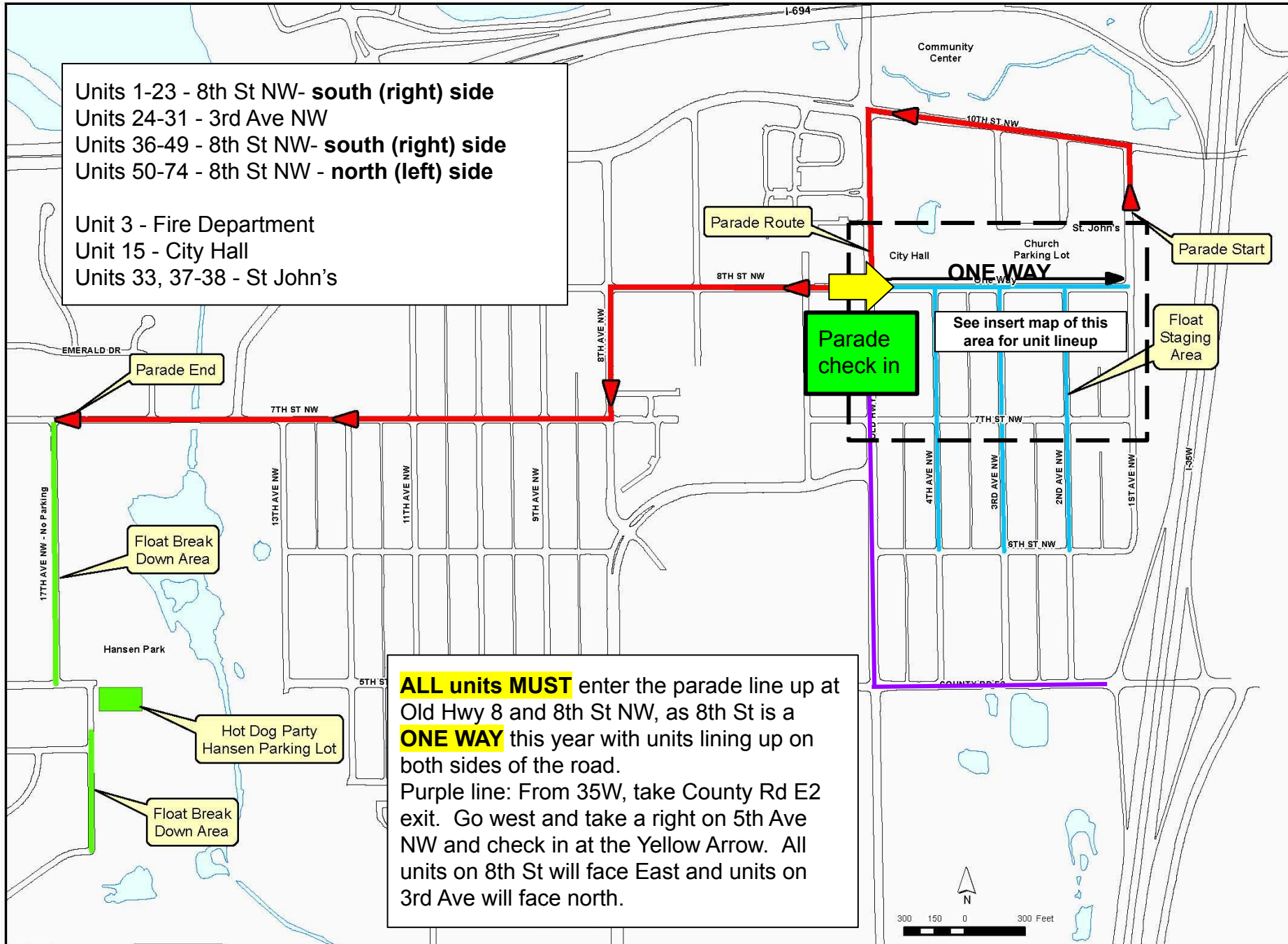

Parade End

Float Break Down Area

Hot Dog Party Hansen Parking Lot

Float Break Down Area

Parade Route

Parade check in

See insert map of this area for unit lineup

Parade Start

Float Staging Area

ALL units MUST enter the parade line up at Old Hwy 8 and 8th St NW, as 8th St is a **ONE WAY** this year with units lining up on both sides of the road.
 Purple line: From 35W, take County Rd E2 exit. Go west and take a right on 5th Ave NW and check in at the Yellow Arrow. All units on 8th St will face East and units on 3rd Ave will face north.

300 150 0 300 Feet